

Statutory Licensing Sub-Committee

03 July 2012

Application for the Variation of a the Premises Licence



Report of Terry Collins, Corporate Director, Neighbourhood Services

Name and Address of Premises: Planet Leisure, Unit 7/8 Maple Way, Newton Aycliffe Business Park, Newton Aycliffe, Co. Durham. DL5 6BF

1. Summary

The Sub-Committee is asked to consider and determine the application for the variation of a premises licence received from:

Ruff N Tumble Adventure World Ltd.

A plan showing the location of the premises is attached as Appendix 1.

A copy of the existing premises licence is attached as Appendix 2.

2. Details of the Application

On 15th May 2012 the Licensing Authority received an application for a variation of a premises licence from Mr. Darren Peckitt of Ruff N Tumble Adventure World Ltd. in respect of Planet Leisure, Newton Aycliffe. A copy of the application is attached as Appendix 3.

The details of the application to vary a premises licence are as follows:

Details of Existing Premises Licence	Details of Variation Application
<p><u>Opening hours of the premises</u></p> <p>10:00 – 00:00 hrs Mon – Thur 10:00 – 01:00 hrs Fri & Sat 10:00 – 23:00 hrs Sun</p>	<p>09:30 - 02:00 hrs Mon - Sun</p>
<p><u>Films (Indoors)</u></p> <p>N/A</p>	<p>Ground & First floors - 09:30 - 02:00 hrs Mon - Sun</p>

<p><u>Live Music (Indoors)</u></p> <p>N/A</p>	<p>Ground & First floors - 09:30 - 01:00 hrs Mon - Sun</p>
<p><u>Recorded Music (Indoors)</u></p> <p>Ground floor only - 10:00 – 00:00 hrs Mon – Thur 10:00 – 01:00 hrs Fri & Sat 10:00 – 23:00 hrs Sun</p>	<p>Ground & First floors - 09:30 – 02:00 hrs Mon - Sun</p>
<p><u>Provision of Facilities for Making Music (Indoors)</u></p> <p>N/A</p>	<p>Ground & First floors - 09:30 – 02:00 hrs Mon - Sun</p>
<p><u>Provision of Facilities for Dancing (Indoors)</u></p> <p>N/A</p>	<p>Ground & First floors - 09:30 – 02:00 hrs Mon - Sun</p>
<p><u>Late Night Refreshment (Indoors)</u></p> <p>Ground floor only - 23:00 – 00:00 Mon – Thur 23:00 – 01:00 Fri & Sat</p>	<p>Ground & First floors - 23:00 – 02:00 hrs Mon - Sun</p>
<p><u>Sale of Alcohol (On Sales only)</u></p> <p>Ground floor only - 12:00 – 00:00 hrs Mon – Thur 12:00 – 01:00 hrs Fri & Sat 12:00 – 22:30 hrs Sun</p>	<p>Ground & First floors - 11:00 – 02:00 hrs Mon - Sun</p>

The application has been advertised on the premises and in the local press as prescribed.

3. The Representations

The Licensing Authority received 2 representations from Responsible Authorities:

- Durham Constabulary
- Public Health

The representations relate to the following licensing objectives:

- The Prevention of Crime and Disorder
- The Prevention of Public Nuisance
- The Protection of Children from Harm

Copies of the representations and additional information from the responsible authorities are attached as Appendix 4.

On 20th June 2012, Mr Peckitt, the applicant, submitted a response to the representation from Public Health. A copy of this document is attached at Appendix 5.

At the time of writing this report, mediation between the applicant and the two responsible authorities is still ongoing and an update on the mediation will be provided to Members at the hearing.

4. The Parties

The Parties to the hearing will be:

- Mr Darren Peckitt of
Ruff N Tumble Adventure World Ltd (the applicant)
- Durham Constabulary (responsible authority)
- Public Health (responsible authority)

5. Durham County Council Statement of Licensing Policy

The Sub-Committee's attention is drawn to the following relevant parts of the Council's Statement of Licensing Policy:

- Section 5.0 Prevention of Crime and Disorder
- Section 7.0 Prevention of Public Nuisance
- Section 8.0 Protection of Children from Harm

Relevant information is attached at Appendix 6.

6. Section 182 Guidance

The Sub-Committee's attention is drawn to the relevant parts of the Guidance issued under section 182 of the Licensing Act 2003 as follows:

- 2.1 Crime and Disorder
- 2.33 Public Nuisance
- 2.41 Protection of Children from Harm

7. For Decision

The Sub-Committee is asked to determine the application in the light of the above having regard to the application, the representations received and any mediation between the applicant and the responsible authorities.

Background Papers:

- Durham County Council's Statement of Licensing Policy
- Guidance issued under section 182 of the Licensing Act 2003

Contact: Yvonne Raine

Tel: 03000 265256

Email: yvonne.raine@durham.gov.uk

APPENDIX 1 – LOCATION PLAN

Google

Address 8 Maple Way
Newton Aycliffe, County Durham
DL5, UK

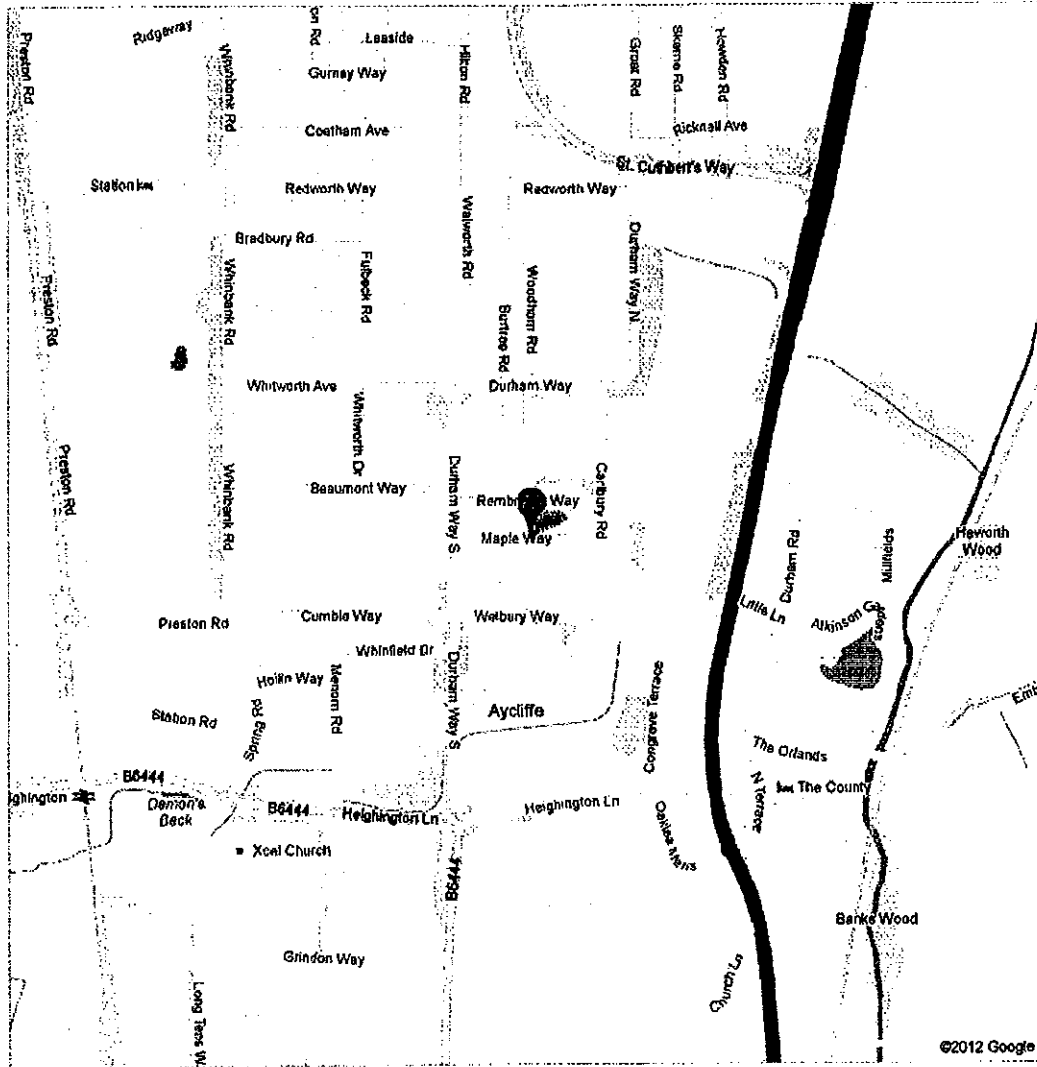

APPENDIX 2 – PREMISES LICENCE



LICENSING ACT 2003 PREMISES LICENCE

Premises Licence Number	DCCPRM50073
Granted	11 MARCH 2011
Issued	15 DECEMBER 2011

Part 1 – Premises details

Postal address of premises, or if none, ordnance survey map reference or description	Issuing Authority
PLANET LEISURE UNIT 7 & 8 MAPLE WAY NEWTON AYCLIFFE INDUSTRIAL ESTATE	DURHAM COUNTY COUNCIL GREEN LANE SPENNYMOOR DL16 6JQ TEL: 01388 816166
Post town: NEWTON AYCLIFFE	Postcode: DL5 6BF
Telephone number: 01325 313777	

Where the licence is time limited the dates N/A

Licensable activities authorised by this licence Recorded music Late Night Refreshment Sale by Retail of alcohol
--

The opening hours of the premises (all times in 24hr format)		
Monday	10:00 – 00:00	Non standard/seasonal timings:
Tuesday	10:00 – 00:00	
Wednesday	10:00 – 00:00	
Thursday	10:00 – 00:00	
Friday	10:00 – 01:00	
Saturday	10:00 – 01:00	
Sunday	10:00 – 23:00	

Where the licence authorises the sale by retail of alcohol whether these are on and/or off sales ON SALES ONLY

The times the licence authorises the carrying out of licensable activities (all in 24hr format)

Recorded Music		
Indoors only		
Monday	10:00 – 00:00	Further details:
Tuesday	10:00 – 00:00	
Wednesday	10:00 – 00:00	Non standard/seasonal timings:
Thursday	10:00 – 00:00	
Friday	10:00 – 01:00	
Saturday	10:00 – 01:00	
Sunday	10:00 – 23:00	

Late Night Refreshment		
Indoors only		
Monday	23:00 – 00:00	Further details:
Tuesday	23:00 – 00:00	
Wednesday	23:00 – 00:00	Non standard/seasonal timings:
Thursday	23:00 – 00:00	
Friday	23:00 – 01:00	
Saturday	23:00 – 01:00	
Sunday		

Sale by retail of alcohol		
On sales only		
Monday	12:00 – 00:00	Further details:
Tuesday	12:00 – 00:00	
Wednesday	12:00 – 00:00	Non standard/seasonal timings:
Thursday	12:00 – 00:00	
Friday	12:00 – 01:00	
Saturday	12:00 – 01:00	
Sunday	12:00 – 22:30	

Part 2

Name, (registered) address, telephone number and email (where relevant) of holder of premises licence	
RUFF N TUMBLE ADVENTURE WORLD LTD	UNIT 7 & 8 MAPLE WAY, AYCLIFFE INDUSTRIAL ESTATE, NEWTON AYCLIFFE, CO DURHAM. DL5 6BF

Registered number of holder, for example company number, charity number (where applicable)	
Company no:	4954798
Charity no:	N/A

Name, address and telephone number of designated premises supervisor where the premises licence authorises the sale by retail of alcohol

DARREN PECKITT
14 SOUTH PARADE, CROFT ON TEES, DARLINGTON, CO DURHAM. DL2 2SN

Personal licence number and issuing authority of personal licence held by designated premises supervisor where the premises licence authorises the sale by retail of alcohol

11/00025/LAPER – ISSUED BY RICHMOND COUNTY COUNCIL

Annex 1 – Mandatory conditions

No supply of alcohol may be made at a time when no designated premises supervisor has been specified in the licence or at a time when the designated premises supervisor does not hold a personal licence or his or her licence has been suspended. Every supply of alcohol under this premises licence must be made or authorised by a person who holds a personal licence.

The responsible person shall take all reasonable steps to ensure that staff on relevant premises do not carry out, arrange or participate in any irresponsible promotions in relation to the premises.

The responsible person shall ensure that no alcohol is dispensed directly by one person into the mouth of another (other than where that other person is unable to drink without assistance by reason of a disability).

The responsible person shall ensure that free tap water is provided on request to customers where it is reasonably available.

The premises licence holder shall ensure that an age verification policy applies to the premises in relation to the sale or supply of alcohol: -

The policy must require individuals who appear to the responsible person to be under 18 years of age (or such older age as may be specified in the policy) to produce on request, before being served alcohol, identification bearing their photograph, date of birth and a holographic mark.

The responsible person shall ensure that:-

(a) Where any of the following alcoholic drinks is sold or supplied for sale or consumption on the premises (other than alcoholic drinks sold or supplied having been made up in advance ready for sale or supply in a securely closed container) it is available to customers in the following measures:-

1. Beer or cider - ½ pint;
2. Gin, rum, vodka or whisky - 25ml or 35ml; and
3. Still wine in a glass - 125ml; and

(b) Customers are made aware of the availability of these measures.

Annex 2 – Conditions consistent with the premises Operating Schedule

The Prevention of Crime and Disorder

32 Camera CCTV will be installed to cover all areas of the premises.
Estate is covered by centrally controlled CCTV system covering the main areas of the estate.
Security will be provided during peak times and be appropriately trained.

Public Safety

Membership system will be employed
All staff members will be appropriately trained (Drugs Awareness, Bar Persons Certificate)

The Protection of Children from Harm

Centre is predominately aimed at family visitors.
All activities will be accessible by children from the age of 5 years old.
Risk assessments will be provided to cover all aspects of the business.

First aiders will be present at all times to ensure injuries are dealt with efficiently and effectively.

Annex 3 – Conditions attached after a hearing by the licensing authority

None

Annex 4 – Plans

Attached



Signature of Authorised Officer
Head of Environment, Health and Consumer Protection

APPENDIX 3 – APPLICATION



Durham County Council
Application to vary a premises licence
Licensing Act 2003

DCC/PRV/3050/12

For help contact
 licensing@durham.gov.uk
 Telephone: 03000 260707 / 01388 816166

12/6

* required information

Section 1 of 20

You can save the form at any time and resume it later. You do not need to be logged in when you resume.

System reference This is the unique reference for this application generated by the system.

Your reference You can put what you want here to help you track applications if you make lots of them. It is passed to the authority.

Are you an agent acting on behalf of the applicant? Put "no" if you are applying on your own behalf or on behalf of a business you own or work for.

Yes No

Applicant Details

* First name

* Family name

* E-mail

Main telephone number Include country code.

Other telephone number

Indicate here if you would prefer not to be contacted by telephone

Are you:

Applying as a business or organisation, including as a sole trader

Applying as an individual

A sole trader is a business owned by one person without any special legal structure. Applying as an individual means you are applying so you can be employed, or for some other personal reason, such as following a hobby.

Applicant Business

* Is your business registered in the UK with Companies House? Yes No

* Registration number

* Business name If your business is registered, use its registered name.

* VAT number Put "none" if you are not registered for VAT.

* Legal status

Continued from previous page...

* Your position in the business

Home country

The country where the headquarters of your business is located.

Registered Address

Address registered with Companies House.

* Building number or name

* Street

District

* City or town

County or administrative area

* Postcode

* Country

The information given here will be saved and will be pre-filled in future forms.

Section 2 of 20

APPLICATION DETAILS

I/we, as named in section 1, being the premises licence holder, apply to vary a premises licence under section 34 of the Licensing Act 2003 for the premises described in section 2 below.

* Premises Licence Number

Are you able to provide a postal address, OS map reference or description of the premises?

Address OS map reference Description

Postal Address Of Premises

Building number or name

Street

District

City or town

County or administrative area

Postcode

Country

Premises Contact Details

Telephone number

Non-domestic rateable value of premises (£)

Continued from previous page...

Section 3 of 20

VARIATION

Do you want the proposed variation to have effect as soon as possible? Yes No

If your proposed variation would mean that 5,000 or more people are expected to attend the premises at any one time, state the number expected to attend

Describe briefly the nature of the proposed variation

Opening of the upstairs of the business for use as a laser arena, karaoke, gaming/gambling machines, live music and the sale of alcohol.

Section 4 of 20

PROVISION OF PLAYS

Will the schedule to provide plays be subject to change if this application to vary is successful?

Yes No

Section 5 of 20

PROVISION OF FILMS

Will the schedule to provide films be subject to change if this application to vary is successful?

Yes No

Standard Days And Timings

MONDAY

Start

End

Start

End

Provide timings in 24 hour clock (e.g., 16:00) and only give details for the days of the week when you intend the premises to be used for the activity.

TUESDAY

Start

End

Start

End

WEDNESDAY

Start

End

Start

End

Continued from previous page...

THURSDAY

Start End
Start End

FRIDAY

Start End
Start End

SATURDAY

Start End
Start End

SUNDAY

Start End
Start End

Will the exhibition of films take place indoors or outdoors or both?

Indoors Outdoors Both

Where taking place in a building or other structure select as appropriate. Indoors may include a tent.

State type of activity to be authorised, if not already stated, and give relevant further details, for example (but not exclusively) whether or not music will be amplified or unamplified.

Pre-recorded instructions and rules for the laser arena
Pre-Recorded music films for the Karaoke Rooms
Pre-Recorded music for the ice rink/bowling

State any seasonal variations for the exhibition of film.

For example (but not exclusively) where the activity will occur on additional days during the summer months.

N/A

Non standard timings. Where the premises will be used for the exhibition of film at different times from those listed above, list below.

For example (but not exclusively), where you wish the activity to go on longer on a particular day e.g. Christmas Eve.

N/A

Section 6 of 20

PROVISION OF INDOOR SPORTING EVENTS

Will the schedule to provide indoor sporting events be subject to change if this application to vary is successful?

Continued from previous page...

Yes

No

Section 7 of 20

PROVISION OF BOXING OR WRESTLING ENTERTAINMENTS

Will the schedule to provide boxing or wrestling entertainments be subject to change if this application to vary is successful?

Yes

No

Section 8 of 20

PROVISION OF LIVE MUSIC

Will the schedule to provide live music be subject to change if this application to vary is successful?

Yes

No

Standard Days And Timings

MONDAY

Start

End

Start

End

Provide timings in 24 hour clock (e.g., 16:00) and only give details for the days of the week when you intend the premises to be used for the activity.

TUESDAY

Start

End

Start

End

WEDNESDAY

Start

End

Start

End

THURSDAY

Start

End

Start

End

FRIDAY

Start

End

Start

End

SATURDAY

Start

End

Start

End

SUNDAY

Start

End

Start

End

Continued from previous page...

Will the performance of live music take place indoors or outdoors or both?

Indoors Outdoors Both

Where taking place in a building or other structure select as appropriate. Indoors may include a tent.

State type of activity to be authorised, if not already stated, and give relevant further details, for example (but not exclusively) whether or not music will be amplified or unamplified.

Live music will be limited to the upstairs function room and on the synthetic ice rink and will be amplified.

State any seasonal variations for the performance of live music

For example (but not exclusively) where the activity will occur on additional days during the summer months.

No seasonal variations.

Non-standard timings. Where the premises will be used for the performance of live music at different times from those listed, above below.

For example (but not exclusively), where you wish the activity to go on longer on a particular day e.g. Christmas Eve.

N/A

Section 9 of 20

PROVISION OF RECORDED MUSIC

Will the schedule to provide recorded music be subject to change if this application to vary is successful?

Yes No

Standard Days And Timings

MONDAY

Start

End

Start

End

Provide timings in 24 hour clock (e.g., 16:00) and only give details for the days of the week when you intend the premises to be used for the activity.

TUESDAY

Start

End

Start

End

WEDNESDAY

Start

End

Start

End

Continued from previous page...

THURSDAY

Start 09:30

End 02:00

Start

End

FRIDAY

Start 09:30

End 02:00

Start

End

SATURDAY

Start 09:30

End 02:00

Start

End

SUNDAY

Start 09:30

End 02:00

Start

End

Will the playing of recorded music take place indoors or outdoors or both?

Where taking place in a building or other structure select as appropriate. Indoors may include a tent.

- Indoors Outdoors Both

State type of activity to be authorised, if not already stated, and give relevant further details, for example (but not exclusively) whether or not music will be amplified or unamplified.

Music will be played throughout the building but at reasonably low levels. The restaurant areas will have low level background music played.

State any seasonal variations for playing recorded music.

For example (but not exclusively) where the activity will occur on additional days during the summer months.

Not Applicable

Non-standard timings. Where the premises will be used for the playing of recorded music at different times from those listed above, list below.

For example (but not exclusively), where you wish the activity to go on longer on a particular day e.g. Christmas Eve.

N/A

Section 10 of 20

PROVISION OF PERFORMANCES OF DANCE

Continued from previous page...

Will the schedule to provide performances of dance be subject to change if this application to vary is successful?

Yes No

Section 11 of 20

PROVISION OF ANYTHING OF A SIMILAR DESCRIPTION TO LIVE MUSIC, RECORDED MUSIC OR PERFORMANCES OF DANCE

Will the schedule to provide anything similar to live music, recorded music or performances of dance be subject to change if this application to vary is successful?

Yes No

Section 12 of 20

PROVISION OF FACILITIES FOR MAKING MUSIC

Will the schedule to provide facilities for making music be subject to change if this application to vary is successful?

Yes No

Standard Days And Timings

MONDAY

Start

End

Start

End

Provide timings in 24 hour clock (e.g. 16:00) and only give details for the days of the week when you intend the premises to be used for the activity.

TUESDAY

Start

End

Start

End

WEDNESDAY

Start

End

Start

End

THURSDAY

Start

End

Start

End

FRIDAY

Start

End

Start

End

SATURDAY

Start

End

Start

End

Continued from previous page...

SUNDAY

Start

End

Start

End

Provide a description of the type of facilities for making music that will be provided.

The karaoke rooms will have the provision of recording the singing from the customers. The maximum number of people in the rooms is envisaged to be 16.

Will the facilities for making music be indoors or outdoors or both?

Indoors Outdoors Both

Where taking place in a building or other structure select as appropriate. Indoors may include a tent.

State type of activity to be authorised, if not already stated, and give relevant further details, for example (but not exclusively) whether or not music will be amplified or unamplified.

Music will be amplified but to comfortable levels.

State any seasonal variations for the provision of facilities for making music.

For example (but not exclusively) where the activity will occur on additional days during the summer months.

N/A

Non-standard timings. Where the premises will be used for the provision of facilities for making music at different times from those listed above, list below.

For example (but not exclusively), where you wish the activity to go on longer on a particular day e.g. Christmas Eve.

N/A

Section 13 of 20

PROVISION OF FACILITIES FOR DANCING

Will the schedule to provide facilities for dancing be subject to change if this application to vary is successful?

Yes No

Standard Days And Timings

MONDAY

Start

End

Start

End

Provide timings in 24 hour clock (e.g., 16:00) and only give details for the days of the week when you intend the premises to be used for the activity.

Continued from previous page...

TUESDAY

Start 09:30

End 02:00

Start

End

WEDNESDAY

Start 09:30

End 02:00

Start

End

THURSDAY

Start 09:30

End 02:00

Start

End

FRIDAY

Start 09:30

End 02:00

Start

End

SATURDAY

Start 09:30

End 02:00

Start

End

SUNDAY

Start 09:30

End 02:00

Start

End

Provide a description of the type of facilities for dancing that will be provided.

The upstairs function room will be equipped with an area for dancing for private parties. It is envisaged that the visitors to the karaoke rooms may engage in dancing. The Ice Rink could be adapted for dancing during live music performances.

Will the facilities for dancing be indoors or outdoors or both?

- Indoors Outdoors Both

Where taking place in a building or other structure select as appropriate. Indoors may include a tent.

State type of activity to be authorised, if not already stated, and give relevant further details, for example (but not exclusively) whether or not music will be amplified or unamplified.

Music will be amplified.

State any seasonal variations for the provision of dancing facilities.

For example (but not exclusively) where the activity will occur on additional days during the summer months.

N/A

Continued from previous page...

Non standard timings. Where the premises will be used for the provision of facilities for dancing at different times from those listed above, list below.

For example (but not exclusively), where you wish the activity to go on longer on a particular day e.g. Christmas Eve.

N/A

Section 14 of 20

PROVISION OF FACILITIES FOR ENTERTAINMENT OF A SIMILAR DESCRIPTION TO THOSE PROVIDED FOR MAKING MUSIC OR DANCING

Will the schedule to provide facilities similar in nature to those provided for making music or dancing be subject to change if this application to vary is successful?

Yes

No

Section 15 of 20

PROVISION OF LATE NIGHT REFRESHMENT

Will the schedule to provide late night refreshment be subject to change if this application to vary is successful?

Yes

No

Standard Days And Timings

MONDAY

Start 09:30

End 02:00

Start

End

Provide timings in 24 hour clock (e.g., 16:00) and only give details for the days of the week when you intend the premises to be used for the activity.

TUESDAY

Start 02:00

End 02:00

Start

End

WEDNESDAY

Start 09:30

End 02:00

Start

End

THURSDAY

Start 09:30

End 02:00

Start

End

Continued from previous page...

FRIDAY

Start 09:30

End 02:00

Start

End

SATURDAY

Start 09:30

End 02:00

Start

End

SUNDAY

Start 09:30

End 02:00

Start

End

Will the provision of late night refreshment take place indoors or outdoors or both?

Where taking place in a building or other structure select as appropriate. Indoors may include a tent.

- Indoors Outdoors Both

State type of activity to be authorised, if not already stated, and give relevant further details, for example (but not exclusively) whether or not music will be amplified or unamplified.

Extension of the provisions of food for special occasions/private functions. Music will be amplified.

State any seasonal variations.

For example (but not exclusively) where the activity will occur on additional days during the summer months.

N/A

Non standard timings. Where the premises will be used for the provision of late night refreshment at different times from those listed above, list below.

For example (but not exclusively), where you wish the activity to go on longer on a particular day e.g. Christmas Eve.

N/A

Section 16 of 20

SUPPLY OF ALCOHOL

Will the schedule to supply alcohol be subject to change if this application to vary is successful?

- Yes No

Standard Days And Timings

Continued from previous page...

MONDAY

Start

End

Start

End

Provide timings in 24 hour clock (e.g., 16:00) and only give details for the days of the week when you intend the premises to be used for the activity.

TUESDAY

Start

End

Start

End

WEDNESDAY

Start

End

Start

End

THURSDAY

Start

End

Start

End

FRIDAY

Start

End

Start

End

SATURDAY

Start

End

Start

End

SUNDAY

Start

End

Start

End

Will the sale of alcohol be for consumption?

- On the premises Off the premises Both

If the sale of alcohol is for consumption on the premises select on, if the sale of alcohol is for consumption away from the premises select off. If the sale of alcohol is for consumption on the premises and away from the premises select both.

State any seasonal variations.

For example (but not exclusively) where the activity will occur on additional days during the summer months.

Sale of alcohol will be in the following areas:

Downstairs bar

Upstairs function room bar

Laser/Karaoke Room bar

The consumption of alcohol will be throughout the public areas of the building

Continued from previous page...

Non-standard timings. Where the premises will be used for the supply of alcohol at different times from those listed above, list below.

For example (but not exclusively), where you wish the activity to go on longer on a particular day e.g. Christmas Eve.

N/A

Section 17 of 20

ADULT ENTERTAINMENT

Highlight any adult entertainment or services, activities, or other entertainment or matters ancillary to the use of the premises that may give rise to concern in respect of children.

Provide information about anything intended to occur at the premises or ancillary to the use of the premises which may give rise to concern in respect of children, regardless of whether you intend children to have access to the premises, for example (but not exclusively) nudity or semi-nudity, films for restricted age groups etc gambling machines etc.

Gambling Machines will be used in the following areas:

- Upstairs Pool Room (restricted area for over 18's). 5 x Category C AWP
- Upstairs Arcade Area - 5 x Cat D AWP
- Dowstairs Bar 1 x Cat C AWP
- Dowstairs Arcade Area - 10 x Cat D AWP

Section 18 of 20

HOURS PREMISES ARE OPEN TO THE MEMBERS AND GUESTS

Standard Days And Timings

MONDAY

Start

End

Start

End

Provide timings in 24 hour clock (e.g., 16:00) and only give details for the days of the week when you intend the premises to be used for the activity.

TUESDAY

Start

End

Start

End

WEDNESDAY

Start

End

Start

End

THURSDAY

Start

End

Start

End

FRIDAY

Start

End

Start

End

Continued from previous page...

SATURDAY

Start 09:30

End 02:00

Start

End

SUNDAY

Start 09:30

End 02:00

Start

End

State any seasonal variations.

For example (but not exclusively) where the activity will occur on additional days during the summer months.

N/A

Non standard timings. Where you intend to use the premises to be open to the members and guests at different times from those listed above, list below.

For example (but not exclusively), where you wish the activity to go on longer on a particular day e.g. Christmas Eve.

N/A

Identify those conditions currently imposed on the licence which you believe could be removed as a consequence of the proposed variation you are seeking.

None

- I have enclosed the premises licence
- I have enclosed the relevant part of the premises licence

Reasons why I have failed to enclose the premises licence or relevant part of premises licence.

Section 19 of 20

LICENSING OBJECTIVES

Describe the steps you intend to take to promote the four licensing objectives:

a) General – all four licensing objectives (b,c,d,e)

Continued from previous page...

If the club wishes members and their guests to be able to consume alcohol on the premises select on, if the club wishes people to be able to purchase alcohol to consume away from the premises select off. If the club wishes people to be able to do both select both.

See responses below.

b) The prevention of crime and disorder

Membership system will be employed
32 camera CCTV has been installed to cover all areas of the premises
Estate is covered by centrally controlled CCTV system covering the main areas of the estate
Security has been provided during peak times and are appropriately trained
All staff members have been appropriately trained (Drugs Awareness, Bar Persons Certificate)
Members of the local pub watch group within Newton Aycliffe
Zero tolerance to drugs
Challenge 25 employed.

c) Public safety

32 camera CCTV has been installed to cover all areas of the premises
Estate is covered by centrally controlled CCTV system covering the main areas of the estate
Security has been provided during peak times
Appropriately trained staff (Drugs Awareness, Bar Person Certificate, etc).
Zero tolerance to drugs.

d) The prevention of public nuisance

Estate is covered by centrally controlled CCTV system covering the main areas of the estate
Security has been provided during peak times and appropriately trained.
All staff members appropriately trained (Drugs Awareness, Bar Person Certificate, etc).

e) The protection of children from harm

Centre is predominantly aimed at family visitors. All activities will be accessible by children from the age of 5 years old.
Risk assessments have been provided to cover all aspects of the business.

First aiders will be present at all times to ensure injuries are dealt with efficiency and effectively.

Section 20 of 20

PAYMENT DETAILS

This fee must be paid to the authority. If you complete the application online, you must pay it by debit or credit card.
Variation Fees are determined by the non domestic rateable value of the premises.

To find out a premises non domestic rateable value go to the Valuation Office Agency site at http://www.voa.gov.uk/business_rates/index.htm

Band A - No RV to £4300	£100.00
Band B - £4301 to £33000	£190.00

Continued from previous page...

Band C - £33001 to £8700	£315.00
Band D - £87001 to £12500	£450.00*
Band E - £125001 and over	£635.00*

*If the premises rateable value is in Bands D or E and the premises is primarily used for the consumption of alcohol on the premises then you are required to pay a higher fee

Band D - £87001 to £12500	£900.00
Band E - £125001 and over	£1,905.00

If you own a large premise you are subject to additional fees based upon the number in attendance at any one time

Capacity 5000-9999	£1,000.00
Capacity 10000 -14999	£2,000.00
Capacity 15000-19999	£4,000.00
Capacity 20000-29999	£8,000.00
Capacity 30000-39000	£16,000.00
Capacity 40000-49999	£24,000.00
Capacity 50000-59999	£32,000.00
Capacity 60000-69999	£40,000.00
Capacity 70000-79999	£48,000.00
Capacity 80000-89999	£56,000.00
Capacity 90000 and over	£64,000.00

* Fee amount (£)

315.00

ATTACHMENTS

- Copy of premises licence
- Premises plan

AUTHORITY POSTAL ADDRESS

Continued from previous page...

Address

Building number or name	Durham County Council
Street	Environment, Health & Consumer Protection
District	Annand House, John Street North
City or town	Meadowfield, County Durham
County or administrative area	
Postcode	DH8 7RS
Country	UK

DECLARATION

* I/we understand it is an offence, liable on conviction to a fine up to level 5 on the standard scale, under section 158 of the licensing act 2003, to make a false statement in or in connection with this application.

Ticking this box indicates you have read and understood the above declaration

This section should be completed by the applicant, unless you answered "Yes" to the question "Are you an agent acting on behalf of the applicant?"

* Full name	
* Capacity	
Date (dd/mm/yyyy)	

Add another signatory

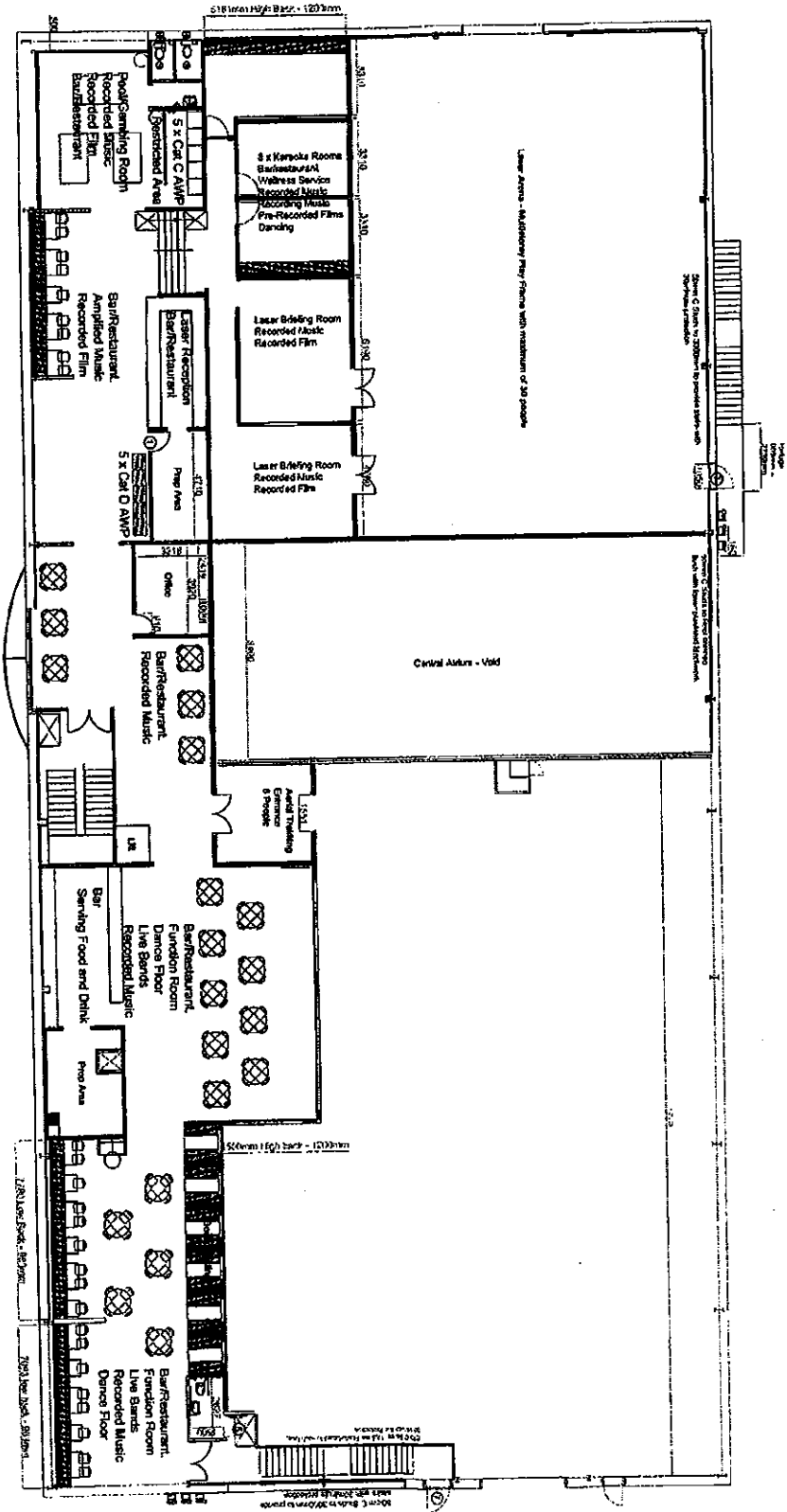

Notes:
 1. All dimensions are in millimeters unless otherwise stated.
 2. All rooms are to be finished to the standard of a high quality commercial premises.
 3. The contractor is to provide a detailed specification for all materials and finishes.
 4. The contractor is to provide a detailed schedule of works.
 5. The contractor is to provide a detailed programme of works.
 6. The contractor is to provide a detailed risk assessment.
 7. The contractor is to provide a detailed health and safety plan.
 8. The contractor is to provide a detailed environmental impact assessment.
 9. The contractor is to provide a detailed social impact assessment.
 10. The contractor is to provide a detailed economic impact assessment.

A
 Construction:
 RENTON CENTRE PARK
 NEWTON AUCKLAND
 Project Location:
 Project Name:
 Project Manager:
 Project Engineer:
 Project Architect:
 Project Designer:
 Project Contractor:
 Project Client:
 Project Date:
 Project No.:

Ryder

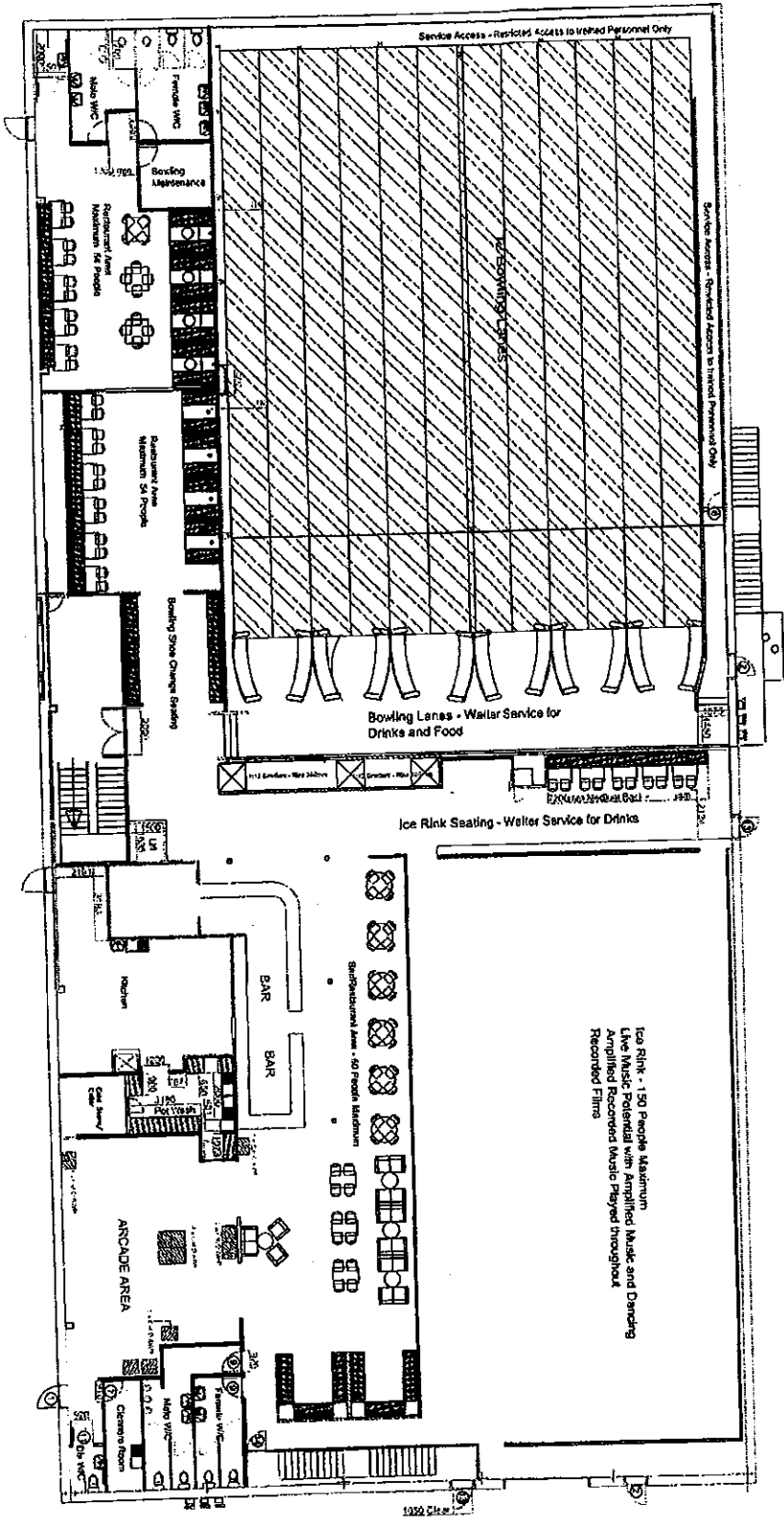

This is a preliminary drawing and is not intended to be used for construction purposes. It is subject to change without notice and is not to be used for any other purpose. All dimensions are approximate and subject to change. The architect assumes no responsibility for the accuracy of the information provided.

CONTRACTOR:
Ryder
1000 G Street, N.W.
Washington, D.C. 20004

OWNER:
Mr. J. H. ...
1000 G Street, N.W.
Washington, D.C. 20004

**APPENDIX 4 – REPRESENTATION
DURHAM CONSTABULARY**

Yvonne Raine

From: Jim Lincoln [jim.lincoln@durham.pnn.police.uk]
Sent: 12 June 2012 15:34
To: Yvonne Raine
Subject: Ruff & Tumble [NOT PROTECTIVELY MARKED]

NOT PROTECTIVELY MARKED

Yvonne,

Durham Constabulary would like to Object to the application for a variation at Ruff & Tumble, Unit 3 Millennium Way, Newton Aycliffe.

This is on the grounds of Prevention of Crime & Disorder and Public Nuisance

*Licence Support Officer - Jim Lincoln
Durham Constabulary
Alcohol Harm Reduction Unit
John Street North
Meadowfield
Co Durham
DH7 8RS
jim.lincoln@durham.pnn.police.uk
6614981 (internal)
0191 3752351 (external)*

NOT PROTECTIVELY MARKED

DURHAM CONSTABULARY - Protecting Neighbourhoods, Tackling Criminals, Solving Problems...Around the Clock

NEIGHBOURHOOD POLICING: Use your postcode to get access to local news and events from your Neighbourhood Policing Team, at <http://www.durham.police.uk/local>

This email carries a disclaimer, a copy of which may be read at <http://www.durham.police.uk/email.php>

Yvonne Raine

From: Tim Robson [tim.robson@durham.pnn.police.uk]
Sent: 13 June 2012 11:08
To: Aileen Gilbert; Garry Keay; Yvonne Raine; Yvonne Raine
Cc: Colin Dobson
Subject: RE: Licensing Act 2003 - Vary Premises App rec'd - Planet Leisure, Newton Aycliffe [NOT PROTECTIVELY MARKED]

NOT PROTECTIVELY MARKED

Hello

The police object to the application for Planet Leisure on the basis that it would undermine the licensing objectives namely

1. The prevention of Crime and Disorder
2. The prevention of Public Nuisance.

A full representation will be submitted but for this initial objection the basis of the undermining of the two objectives are as follows.

- The operating schedule is wholly inadequate on the basis of the ages of patrons that may attend the premise whilst open.
- The premise is situated in an industrial estate and sells alcohol, there are no buses or taxis near to this location and those drinking will be inclined to walk from the premise and ultimately individuals walking home under the influence of alcohol are inherently noisy.
- This area is not conducive with a terminal hour for all activities being 2am.
- There is no control over the time at which children should leave the premise, therefore children of ages 5yrs and above may remain in the premise during all hours of operation up until 2am.
- That children in this premise will be in an environment where there is access to alcohol and measures to ensure the safety of the children have not been put in place on the operating schedule.
- The premise has 10 AWP machines which may be monitored on camera but are out of the line of sight of management and are therefore vulnerable for use by under 18s.

This application causes me to have concerns in a number of other areas of which I will require the need to investigate further.

Regards
Tim

Sgt 1590 Tim Robson

Alcohol Harm Reduction Unit

Annand House

John Street North

Meadowfield

Durham

DH7 8RS

Tel 0191 3754980

**APPENDIX 4 – REPRESENTATION
PUBLIC HEALTH**

Yvonne Raine

From: Garry Keay
Sent: 12 June 2012 16:35
To: Yvonne Raine
Cc: Aileen Gilbert
Subject: RE: Licensing Act 2003 - Vary Premises App rec'd - Planet Leisure, Newton Aycliffe

Sent on behalf of Aileen Gilbert, Alcohol Co Ordinator

Please accept this as a representation in respect of this application.

The application, which will allow licensable activities until 0200hrs, states that all activities will be available to children as young as 5 years old.

The operating schedule does not adequately outline how the objective: Protection of Children From Harm will be promoted. It merely states that "risk assessments" have been done. In order to be satisfied that this licensing objective will be promoted a far more detailed and robust statement regarding their policies should be provided.

Further information supporting this representation will be forthcoming in separate correspondence.

Regards

Garry Keay
Licensing Enforcement Team Leader

Yvonne Raine

From: Garry Keay
Sent: 13 June 2012 11:36
To: Yvonne Raine
Subject: FW: Licensing Act 2003 - Vary Premises App rec'd - Planet Leisure, Newton Aycliffe

Re Ruff n Tumble Adventure World

- There is no indication of a policy and action on proxy sales to avoid children and young people gaining access to alcohol via adults over 18
- Concerns re an activity centre where there children access all parts of a premises where there is alcohol throughout without a clear plan in place for their supervision either by their parents / carers or appropriately checked employed adults
- There is no clear oversight of staff ensuring the safety of children where they are being cared for by adults whose capacity to be responsible for them is reduced by alcohol. No adult should leave the premises drunk in charge of children.
- Concerns that the provision of films, live music, karaoke have not clearly considered any age restrictions and are suitable for children and young people including advertising
- Whilst the centre is predominately aimed at families there are clearly adult activities provided which are likely to attract adults requiring their own entertainment until the early hours. It is unacceptable that there are no age and timing restrictions on children and young people's access to the premises. This licence if granted would permit access by children during opening times
- Detailed risk assessments will need to be provided to demonstrate that the protection of children has been thoroughly considered

Other thoughts -

1. Multi storey play frame - is it really for children over five?
2. Access by children to second hand smoke??

Aileen

Please Note New Contact Details

Aileen Gilbert
Alcohol Harm Reduction Coordinator
Durham County Council
Room 2/122, County Hall, Durham, DH1 5TS

Tel: 03000 265441

Yvonne Raine
Acting Licensing Team Manager
Durham County Council
Neighbourhood Services Department
Environment, Health and Consumer Protection
Licensing Services
PO Box 617
Durham
DH1 9HZ

Dear Yvonne

Re:-

Application Type - Application to Vary a Premises Licence (Variation of hours and permit licensable activities on 1st floor)
Applicant: Ruff N Tumble Adventure World Ltd
Premises - Planet Leisure, Unit 7/8 Maple Way, Newton Aycliffe Business Park, Newton Aycliffe. DL5 6BF
Date of Application - 15 May 2012 **Last date for representations** - 12 June 2012

Thank you for the information in relation to the above licensing application. A representation was made on 12th June 2012. Public Health, a licensing authority wish to object to the licensing application on the basis that it would undermine the licensing objectives namely:-

- The protection of children from harm.

The objection is based on:-

- Whilst the centre is predominately aimed at families there are clearly adult activities provided which are likely to attract adults requiring their own entertainment until the early hours. It is unacceptable that there are no age and timing restrictions on children and young people's access to the premises. This licence if granted would permit access by children during opening times until 2am. This in turn would create the likelihood of children being exposed to unacceptable levels of adult behaviours
- The provision of gaming machines on the premises with no supervisory oversight permits those under 18 to access gambling activities. This is unacceptable in the protection of children from harm.
- There are no clear expectations in place for the supervision of children either by their parents / carers or appropriately checked employed adults in an activity centre where children access all parts of a premises and there is alcohol throughout. Without clear expectations

there are no appointed adults who have responsibility for the care and protection of children.

- There is no expectation that Level 1 staff training on safeguarding will be provided to staff working in a family environment. This is required to increase awareness to staff working in an environment where children are welcome and which has the potential to attract those wishing to have access to children.
- There is no clear oversight of staff ensuring the safety of children where they are being cared for by adults whose capacity to be responsible for them is reduced by alcohol. No adult should leave the premises drunk in charge of children putting them at risk of serious harm.
- There is no indication that the provision of films, live music, karaoke has clearly considered any age restrictions and will be suitable for children and young people including the advertising of products designed for adults.
- There is no indication of a policy and subsequent actions on proxy sales to avoid children and young people gaining access to alcohol via adults over 18.
- The use of multi storey play frame for over 5's requires further clarification and the activity risk assessed.
- There is no indication that children will be protected from second hand smoke whilst accessing the premises increasing their health risks. A separate smoking area where children cannot access is needed.
- The operating schedule does not adequately outline how the objective: 'Protection of Children From Harm' will be promoted. It merely states that "risk assessments" have been done. In order to be satisfied that this licensing objective will be promoted a far more detailed and robust statement regarding their policies should be provided.

**APPENDIX 5 – APPLICANTS' RESPONSE TO
REPRESENTATION**

Yvonne Raine
Acting Licensing Team Manager
Durham County Council
Neighbourhood Services Department
Environment, Health and Consumer Protection
Licensing Services
PO Box 617
Durham
DH1 9HZ

Dear Yvonne

Re:-

Application Type - Application to Vary a Premises Licence (Variation of hours and permit licensable activities on 1st floor)
Applicant: Ruff N Tumble Adventure World Ltd
Premises - Planet Leisure, Unit 7/8 Maple Way, Newton Aycliffe Business Park, Newton Aycliffe. DL5 6BF
Date of Application - 15 May 2012 **Last date for representations** - 12 June 2012

Thank you for the information in relation to the above licensing application. A representation was made on 12th June 2012. Public Health, a licensing authority wish to object to the licensing application on the basis that it would undermine the licensing objectives namely:-

- The protection of children from harm.

The objection is based on:-

- Whilst the centre is predominately aimed at families there are clearly adult activities provided which are likely to attract adults requiring their own entertainment until the early hours. It is unacceptable that there are no age and timing restrictions on children and young people's access to the premises. This licence if granted would permit access by children during opening times until 2am. This in turn would create the likelihood of children being exposed to unacceptable levels of adult behaviours

The current licence does not restrict the times that children are permitted to the premises. However, we locally enforce the need for parental supervision even though the current license does not stipulate is as a requirement. We, therefore, propose to amend the license such that all children 16 years and under have to be accompanied by an adult after 9:00pm and that all children 11 years and under must be accompanied by an adult at all times. We also propose to revert back to the current licenced hours with the exception of bank holidays in which we request a 2:00am close (i.e. New Years Eve). However,

certain activities require parental supervision at all times, namely, the Aerial Trekking and Karaoke Rooms* (when open) and this is currently in force.

- **The provision of gaming machines on the premises with no supervisory oversight permits those under 18 to access gambling activities. This is unacceptable in the protection of children from harm.**

Per previous comments, all children under the age of 11 must be accompanied at all times and children under the age of 16 must be accompanied by an adult after 9:00pm. The area proposed will be supervised by staff and there is CCTV covering the area for constant monitoring.

- **There are no clear expectations in place for the supervision of children either by their parents / carers or appropriately checked employed adults in an activity centre where children access all parts of a premises and there is alcohol throughout. Without clear expectations there are no appointed adults who have responsibility for the care and protection of children.**

Per previous comments, we already insist that adults accompany children upto 11 years old. As part of this licence variation we propose to mandate adult supervision for children under 11 years old. Activities that require Centre Supervision have CRB checked staff (Aerial Trekking) plus the requirements for adult consent for all participants under the age of 18 years old.

- **There is no expectation that Level 1 staff training on safeguarding will be provided to staff working in a family environment. This is required to increase awareness to staff working in an environment where children are welcome and which has the potential to attract those wishing to have access to children.**

We will commit that all supervisory staff will undertake the Level 1 Training on Safeguarding as a requirement of the licence. This will be extended to the staff who have specific responsibilities for the supervision of the high risk activities (Aerial Trekking).

- **There is no clear oversight of staff ensuring the safety of children where they are being cared for by adults whose capacity to be responsible for them is reduced by alcohol. No adult should leave the premises drunk in charge of children putting them at risk of serious harm.**

The Licencing Law does not permit us to sell alcohol to members of the public who are demonstrably drunk. The Centre has a refusals register for customers who are drunk and this is maintained by all bar staff. We, therefore, are confident that our measures are robust to protect

children from harm in this regard. In addition, we prohibit the use of the ice rink and aerial trekking to anyone who has consumed alcohol.

- There is no indication that the provision of films, live music, karaoke has clearly considered any age restrictions and will be suitable for children and young people including the advertising of products designed for adults.

The provision of films is limited to the instruction video for the laser arena advising the players on the rules and procedures. This will be classified a 'U' and no age restrictions apply.

The Karaoke Systems are restricted to the 2 private rooms and will be censored to remove any foul language (standard in the industry). Children using the Karaoke rooms will have to have parental supervision and there is CCTV in each room to safeguard the equipment.

There is no intention to advertise products.

- There is no indication of a policy and subsequent actions on proxy sales to avoid children and young people gaining access to alcohol via adults over 18.

We already employ a Company Policy of refusing the supply alcohol to over 18 years old who's intention is to supply an under 18. We operate Challenge 25 within the facility and staff constantly monitors this situation. Third Party Security is employed at the busiest times to ensure the Company Policy is enforced. In addition, although the Licencing Law permit's the consumption of alcohol to under 18's when consumed with a meal, we enforce the Company Policy for alcohol to over 18's only.

- The use of multi storey play frame for over 5's requires further clarification and the activity risk assessed.

The activity will be fully risk assessed prior to opening and staff fully trained in its operation and supervision. Staff supervision is mandated for this activity and these staff will be CRB checked. This facility does not constitute a licenced activity.

- There is no indication that children will be protected from second hand smoke whilst accessing the premises increasing their health risks. A separate smoking area where children cannot access is needed.

The smoking area for the building is situated 10metres from and adjacent to the main entrance. This is considered appropriate to prevent smoke inhalation by visitors to the centre. Plans can be modified to show its location.

- The operating schedule does not adequately outline how the objective: 'Protection of Children From Harm' will be promoted. It merely states

that "risk assessments" have been done. In order to be satisfied that this licensing objective will be promoted a far more detailed and robust statement regarding their policies should be provided.

Detailed risk assessments are available for the following areas (*or will be completed prior to opening to the general public).

Bowling Area
Arcade Area
Ice Rink
Aerial Trekking
Bar and Reception Areas
Laser Arena*
Karaoke Room*
Games Room*

In addition, full maintenance and daily safety checks are conducted (*or will be conducted when completed) for the following areas:

Bowling Area
Ice Rink
Aerial Trekking
Laser Arena*

Other specific policies and practices employed to protect Children from Harm are as follows:

32 Camera CCTV system covering the entire premises currently in force.

Staff training on the sale of alcohol to customers.

Challenge 25 employed across the site

Company policy to allow the consumption of alcohol to over 18's only irrespective of the provision of food.

Refusal register maintained by all bar staff for the attempted purchase of alcohol by a person who is drunk.

Company Policy that prohibits the use of the ice rink, aerial trekking and laser arena* if the customer has consumed alcohol.

Active participant to the Pub Watch Scheme operated by Durham Constabulary

CRB checks for all staff that are responsible for the supervision of children.

All staff have been trained in first aide.

Parental supervision required for all children 11 years old and under.

Parental supervision required for all children 16 years and under after 9:00pm.

Parental Supervision required for all children and at all times for the Karaoke Rooms and Aerial Trekking activities.

Karaoke tracks to be checked by Staff for explicit/inappropriate lyrics and censored prior to being made available to the Customers.

Further commitments

Level 1 Safeguarding to be completed by all Centre Management

Level 1 Safeguarding to be completed by all Activity Supervisors.

**APPENDIX 6 – STATEMENT OF
LICENSING POLICY**

APPENDIX 6

5.0 The Prevention of Crime and Disorder

5.1 Licensed premises, especially those offering late night / early morning entertainment, alcohol and refreshment may sometimes, if not properly managed, become a source of public nuisance, generating crime and disorder problems.

5.2 As a matter of Policy the Licensing Authority will require every holder of a Licence, Certificate or Permission to be responsible for minimising the impact of crime, disorder and anti-social behaviour by their patrons both on and within the vicinity of their premises, including for example on the pavement, in a beer garden or in a smoking shelter. The Licensing Authority suggests that applicants demonstrate in their Operating Schedules that suitable and sufficient measures, ranging from the design and layout of the premises through to the daily operation of the business have been identified and will be implemented and maintained with the intention of preventing crime and disorder. Procedures to deal with drunken customers, violence and anti social behaviour in and outside premises and the provision of closed circuit television in certain premises must be considered by applicants and licencees when addressing this issue. The Licensing Authority will also expect that Personal Licence holders will actively participate in established "Pubwatch" schemes where issues relating to crime and disorder can be addressed. The Licensing Authority support involvement in "Best Bar None" initiative which enables premises to demonstrate good safe operating procedures.

5.3 The Licensing Authority considers the effective and responsible management of the premises through competent and efficient and regular instruction, recorded training, supervision of staff and the adoption of good practice, such as 'Challenge 25', to be among the most important control measures for the achievement of all Licensing Objectives. The Licensing Authority will take a positive view of anyone who invests in appropriate training, and in particular nationally accredited qualifications tailored to the Licensing sector. Training records should be kept available for inspection by all enforcement agencies.

5.4 The application for premises selling alcohol must identify a Designated Premises Supervisor (DPS) who must also hold a Personal Licence. The DPS does not have to be present on the premises at all times when alcohol is being sold. However, the DPS and Premises Licence Holder remain responsible for the premises at all times. It is important that there is an accountable, responsible person present when alcohol is being sold or supplied to ensure, for example, that alcohol is not sold to persons who have had too much to drink, or to those under the age of 18 years, and so that the Licensing Authority and Police can discuss any problems or issues arising from the licensable activities offered on the premises. The Licensing Authority considers it to be good practice if the DPS or Premises Licence Holder is present in the licensed area of the premises:

- Between 22:00 hours and closing time, when the premises is one that regularly opens after midnight for both regulated entertainment and the sale or supply of alcohol for consumption on the premises.
- At all times when the premises is a "vertical drinking establishment" where little or no seating is provided.
- At times where there is a substantial increase in customers i.e. for televised major sporting events etc.

5.5 The Licensing Authority will only impose a maximum number of people that can attend a premises or an event where there is a clear and justifiable need in respect of that particular premises or event, any such decision will be based on the nature and style of the operation. The Licensing Authority will consider information provided by the applicant and any other body, in particular the Council's Building Control Section, Environmental Health Section and the Durham and Darlington Fire and Rescue Service before setting a maximum number. Applicants will be expected to detail the arrangements that would be put in place e.g. provision of door staff to ensure that the permitted number of people attending the premises or event will not be exceeded.

5.6 Whenever security operatives/door supervisors are employed at licensed premises to carry out security functions they must be licensed by the Security Industry Authority (SIA). If a licensee directly employs security operatives they will need to be licensed by the SIA as a supervisor/manager.

5.7 The numbers of licensed door supervisors, both male and female, required at any premises will be dependant upon the nature of the activities licensed and the characteristics and capacity of the establishment and hours of trading.

5.8 In addition to the requirement of the Licensing Authority to promote the Licensing Objectives, the Council also has a duty under Section 17 of the Crime and Disorder Act 1998 to do all it reasonably can to prevent crime and disorder in its area and to consider crime and disorder in its decision making process.

7.0 Prevention of Public Nuisance

7.1 Licensed premises, especially those operating late at night and in the early hours of the morning, can cause a range of nuisances impacting on people living, working or sleeping in the vicinity of the premises.

7.2 The concerns relate, amongst other things, to litter, light pollution, noxious odours and noise nuisance resulting from music, human voices, ventilation equipment and vehicles. The Licensing Authority will expect applicants to demonstrate that suitable and sufficient measures have been identified, and will be implemented and maintained, with the intention of preventing public

nuisance relevant to the individual style and characteristics of the premises and events.

7.3 If an external structure or area is to be used by customers, whether for consumption of alcohol or smoking, the applicant will be expected to offer measures designed to minimise its impact on local residents in respect of both public nuisance and crime and disorder. These measures may include a restriction on hours that areas / structures will be used, appropriate signage requesting customers to consider local residents and monitoring of such areas by staff.

7.4 The placement of tables and chairs outside of licensed premises may give rise to public nuisance including noise and litter. When tables and chairs are situated on the public highway relevant consents will be required. Enquiries for consents should be directed to the Council's Licensing Team. In predominantly commercial areas such as shopping centres the Licensing Authority will normally allow the use of tables and chairs outside but will expect them to be removed before the premises close, and any resulting litter/ debris cleared away.

7.5 Applicants should give consideration to reducing potential noise nuisance by, for example:

- Assessment of likely noise levels in the premises.
- Assessment of likely noise levels if outdoor drinking is allowed.
- The sound insulation the building would provide (e.g. double glazing, openable windows, double doors / lobbies to entrances).
- The distance and direction to the nearest noise sensitive premises.
- Likely noise sources outside of the premises (e.g. emptying bottle bins, taxis, unruly customers leaving the premises).
- Dispersal of patrons – where necessary the Licensing Authority will expect a dispersal policy for patrons at the end of the evening. The policy will specify such issues as alterations to the style and volume of music played, public address announcements and use of appropriate signage at exits.
- Ways to limit noise / disorder from patrons leaving the premises.

7.6 The extent to which the above matters will need to be addressed will be dependant on the nature of the area where the premises are situated, the type of premises concerned, the licensable activities to be provided, operational procedures and the needs of the local community.

7.7 Applicants are advised to seek advice from Durham County Councils Environmental Health Team and incorporate any recommendations in their Operating Schedule before submitting their applications.

8.0 Protection of Children from Harm

8.1 While the Act does not prohibit children from having free access to any licensed premises, the Licensing Authority recognises that limitations may have to be considered where it appears necessary to protect children from physical, moral or psychological harm.

8.2 The Act makes it an offence for any child under the age of 16 who is not accompanied by an adult from being present:

- at any time on pub premises, or other premises being used exclusively or primarily for the supply of alcohol for consumption on those premises; or
- between the hours of midnight and 05:00 hours on restaurant premises or other premises that supply alcohol for consumption on the premises
- the Licensing Authority will judge the merits of each separate application before deciding whether to impose conditions limiting the access of children to individual premises where it is necessary to prevent physical, moral or psychological harm.

8.3 The Licensing Authority may consider the following when dealing with a Licence application where children may have limited access:

- Limitations on the hours when children may be present.
- Limitations on under 18s
- Limitations or exclusion when certain activities are taking place.
- Requirements for an accompanying adult to be present.
- Full exclusion of people under 18 from the premises when certain licensable activities are taking place (e.g. entertainment of a sexual nature).
- Limitations on the parts of premises to which children might be given access.
- Any other limitations appropriate to the application and according with the four Licensing Objectives.

8.4 The Licensing Authority will work closely with the Police and the Council's Trading Standards Service to ensure the appropriate enforcement of the law,

especially relating to the sale and supply of alcohol to children. Alcohol must not be served to persons under the age of 18, except in limited circumstances allowed by the law, and then only after verifying a person's proof of age e.g. 16 and 17 year-olds may drink beer, wine or cider with a table meal in relevant premises, where accompanied by an adult aged 18 years or over. The currently accepted verifications for proof of age are a passport, a photo card driving licence or a proof of age scheme such as Challenge 25

Events which are aimed at children under the age of 18 years on licensed premises will not be looked on favourably by the licensing authority unless the applicant can demonstrate that all safeguards for children have been addressed such as the removal of alcohol advertising.

8.5 Recorded staff training programmes, the use of a refusals register, in-store signage and limited access to alcoholic drink can all reduce the likelihood of illegal sales.

8.6 The Licensing Authority commends the use of the 'Portman Group' Code of Practice on the naming, packaging and the promotion of alcoholic drinks in all licensed premises.

Access to Cinemas

8.7 In the case of premises which are used for film exhibitions, applicants should include in the Operating Schedule arrangements for restricting access only to those children who meet the required age limit, in line with any certificate granted by the British Board of Film Classification or, in specific cases, a certificate given to the film by the Local Authority.

8.8 The Act provides that it is mandatory for Licensing Authorities to include a condition in all Premises Licences and club certificates authorising the exhibition of film, for the admission of children to the exhibition of any film to be restricted in accordance with the recommendations given to films either by the British Board of Film Classification or by the Licensing Authority itself.

8.9 Should the Licensing Authority need to adopt its own system of film classification the information regarding such classifications will be published on the Local Authority's website.

Children and Public Entertainment

8.10 Many children go to see and / or take part in an entertainment arranged especially for them. For example, children's film shows and dance or drama school productions, and additional arrangements may be required to safeguard them while at the premises.

8.11 Where entertainment requiring a Licence is specifically presented for children, the Licensing Authority will normally expect the presence of at least one member of staff from the Licensed premises for every 50 children present to ensure their safety and protection from harm and to control their access

and egress from the premises. The Council will require those caring for or supervising children to have undergone an appropriate Criminal Record check with the Criminal Records Bureau.

8.12 With regard to this Licensing Objective, the Licensing Authority considers Durham County Council Safeguarding Children Board to be the competent authority for matters relating to the protection of children from harm. A protocol exists between Durham Local Safeguarding Children Board and Durham Constabulary. All safeguarding concerns identified as a result of premises, personal applications and all variations to licences are covered by this protocol.

8.13 Applicants are advised to seek advice from the Local Safeguarding Children Board and incorporate any recommendations in their Operating Schedule before submitting their applications.

This page is intentionally left blank